

**PERFORMA**

*Commercial tap, mixer  
and shower solutions*



# Pegler Yorkshire

*Unrivalled quality, innovation,  
customer service and long-term  
value for money*

As part of the global Aalberts Industries NV Group, Pegler Yorkshire is one of Britain's largest and most respected manufacturers of innovative market-leading products for today's ever more demanding and diverse plumbing and heating industries.

Behind every one of the company's very extensive portfolio of famous brand names are two unparalleled key benefits: more than two hundred years of priceless expertise and experience combined with continuous investment in research, development, new technology, advanced production facilities and, of course, in people dedicated to the task.

Hence Pegler Yorkshire's ability to not only sustain but to build upon a reputation the world over for exceptional quality, performance, reliability and whole-life value for money.

Increasingly, Pegler Yorkshire's substantial resources are also focused on developing solutions which, where possible, address crucial environmental issues such as saving water and reducing energy consumption at every opportunity.

So when you purchase or specify any of our tried and trusted products, you are acquiring far more than a means of simply doing a job. You are guaranteeing a job very well done every time.

And all backed by impeccable customer service, training and technical support, with comprehensive warranties and long term parts availability.

## Standards

At Pegler Yorkshire we are dedicated to designing, developing and manufacturing products of the highest quality. We are members of numerous standards committees and take an active part in their development. Our products, where applicable, comply with the relevant British, European and International standards. Whatever the latest developments, we guarantee that our products will always meet the latest and highest standards.



## Trade bodies

Pegler Yorkshire is pleased to be associated with several influential organisations within the industry.



Association of Plumbing and Heating Contractors



The Bathroom Manufacturers Association



Construction Products Association

## Brass

The Brass Page for specifiers, designers, engineers and manufacturers



British Plumbing Employers Council



Builders Merchants Federation



The Copper Development Association



The UK Copper Board



Institute of Plumbing



Heating and Ventilating Contractors Association



Thermostatic Mixing Valve Manufacturers Association



Scottish and Northern Ireland Plumbing Employers Federation



## Commercial tap, mixer and shower solutions

### Introduction

Choosing the best possible solution for the job is critical in a commercial arena – particularly where the issues concerned are as important as saving water and helping to prevent both scalding and cross-contamination.

Water is one of the world's most vital resources - a precious and increasingly costly commodity. Performa water saving flow controls are now being used in a diverse and ever growing number of applications.

### The choices that deliver so many important and proven benefits

The comprehensive and innovative range of products featured in these pages has been created and refined by Pegler Yorkshire over many years to meet your very specific needs – from manual and electronic self-closing basin taps and mixers to TMV3-approved thermostatic controls to shower heads, basin spouts, accessories and more.

#### Unrivalled experience and expertise

Pegler Yorkshire has worked closely with the healthcare sector for more than 80 years – experience which, in broad terms, covers all these vital areas of expertise:

- Helping to prevent cross-contamination: non-touch taps greatly reduce the risk.
- Anti-scalding: TMV3-approved thermostatic valves are proven to offer increased protection against any sudden sharp increase in hot water temperature.
- Conserving water: self-closing flow controls are an increasingly important requirement in the commercial sector.
- Easy operation: innovations such as knee- or elbow-operated lever flow controls and lever-action basin taps are essential for people with restricted hand movement.

#### Engineered to perform better and last longer

Every product in the Pegler Yorkshire range is designed and manufactured to exacting standards to guarantee outstanding quality, long-life reliability and whole-life value for



money. Other distinguishing Pegler Yorkshire hallmarks are robust construction (to deter vandalism), easy and user-friendly operation, and safe and simple installation.

### Features and benefits

Pegler Yorkshire products have long been renowned for exceptional quality, reliability and performance, simply because these qualities are built-in and painstakingly applied through every stage of the product life cycle, from concept to the end of the production line.

Paramount to these qualities is the critical choice of materials. Chromium plate and nickel feature strongly in many Pegler Yorkshire taps, mixers, showers and valves to help ensure outstanding durability and a long, trouble-free working life.

Where appropriate, further assurances are guaranteed by testing, compliance and approvals with standards such as ISO9227 service condition 2, BS 1010, BS 5412, TMV2 and TMV3 as appropriate.

Today's emphasis on saving water and energy at every turn, particularly in social housing, healthcare and commercial multi-point applications, is evident across the entire Pegler Yorkshire taps and mixers portfolio – from the market-leading Performa utility range to sophisticated electronic thermostatic mixing valves which protect against any possibility of scalding.

In short, every Performa product is built to work harder and last longer – thereby fulfilling the Pegler Yorkshire promise of lasting and unsurpassed quality.

## Approvals



BS1010 and BS5412 taps have been granted approval by BSI for products complying with the required British Standard.



Many products have been certified by WRAS and are audited periodically. Products not claiming WRAS are manufactured using WRAS materials.

## TMVA scheme



Thermostatic Mixing Valve Manufacturers Association

TMVA is the representative for UK companies within European standards activities. It plays a key part in promoting the safety of hot water systems. As part of the TMVA membership we offer a comprehensive range of thermostatic products approved under the BuildCert scheme.



■ **TMV2 Scheme** – certifies Type 2 Thermostatic Mixing Valves for the domestic market. For use in hot water systems in domestic premises.



■ **TMV3 Scheme** – certifies Type 3 Thermostatic Mixing Valves manufactured to meet the highest specification required by the NHS Estates D08 standard for Mixing Valves within healthcare premises in the United Kingdom.

## Product standards and approvals

■ **Model Engineering Standard D08** Thermostatic Mixing Valves (Healthcare Premises) 1997 for TMV3. This standard is regulated by WRAS under the BuildCert Scheme. This is of high priority where applicable.

■ **Product to be designed to meet the dimensional requirements of BS 5412 and EN 200**, this includes areas such as air gaps, spout lengths, tail bores, flow rates etc., unless otherwise stated.

**Products also designed to take into consideration the standards below.**

■ **HMT04** The control of legionella, hygiene, “safe” drinking water systems 2006.

■ **HMT 2027** ‘Hot and Cold Water Supply, Storage and Mains Services’.

■ **Function DDA** (Disability Discrimination Act) 1995.

■ **BS 8300** Design of buildings and their approaches to meet the needs of disabled people. Code of practice 2001.

■ **BS 6465** Sanitary Installation. Code of practice for scale of provision, selection and installation of sanitary applications: 1995.

■ **BS 7942** Thermostatic mixing valves for use in care establishments.

## ISO standard



It is the policy of Pegler Yorkshire Ltd to provide a range of products and services which meet, or exceed, the requirements of our customers in respect of quality, cost and delivery.

This is achieved through the continuous improvement of our Quality Management System in line with the requirements of BS EN ISO9001: 2000.



## BSI standards

Where appropriate Pegler Yorkshire tap products are designed and manufactured in line with the relevant BSI Standards, which are globally recognised for their independence, production innovation and information that promotes and shares best practice.



FM 27630

Many of the products listed within this document have been designed in conjunction with the standards listed below.

■ **BS 1010** A mainly dimensional standard. Covers 1/2” and 3/4” taps and mixers. Components conforming to this standard are interchangeable.

■ **BS 5412** A “performance” standard, introduced in 1976 for taps and mixers only. The focus is on the physical performance of the fitting, covering: life testing, flow rates, pressure and strength testing etc. Includes dimensional requirements sufficient to allow fitting on standard bathroom and kitchenware, as well as conformance with The Water Regulations. Fittings rated use at a minimum pressure of 0.1bar.

■ **BS EN 200** The European version of BS 5412. Fittings rated use at a minimum pressure of 0.5bar.

- **BS EN 816** Covers the design and performance of single and mixer taps with automatic shut-off for installation into washrooms. Requirements include: fixing dimensions, outlet requirements, pressure testing and performance requirements (including time/flow curves).

- **BS EN 1287** Covers Thermostatic Mixing Valves (TMV) to the requirements of TMV 2, which is regulated by WRAS under the BuildCert scheme. Very stringent performance requirements covering temperature control and fail-safe performance. Valves rated at 10bar static max, with recommended pressures of 0.2 – 0.5bar dynamic. Dimensional requirements cover connections and outlets.

- **BS EN 1111** High pressure version of BS EN 1287. Valves rated at 10bar static max, with recommended pressures of 1.0 – 5.0bar dynamic.

- **BS EN 15091** Covers electrically-operated taps, valves, mixing valves and sanitary appliances. Includes performance, electrical, safety, marking, mechanical testing, noise (environmental), pressure and leak testing.



- **BS Kitemark** Approval granted by BSI for products complying with the required British Standard. Allows product to carry the British Standard Kitemark. Companies usually need to conform to ISO 9000 Quality Assurance Scheme.

**NB. All fittings attached to UK water supplies MUST comply with The Water Supply (Water Fittings) Regulations 1999 or the Water Byelaws 2004 (Scotland), dependant on where in the UK they are fitted.**

## CE standard



The CE mark on a product is our declaration that the product conforms to all applicable EU directives and that appropriate conformity assessment procedures have been completed.

## Quality

By using only the very best materials currently available, advanced manufacturing processes and applying the most stringent quality control standards, Pegler Yorkshire consistently delivers outstanding product reliability. This in turn means the assurance of a long working life and unbeatable value for money.

## Watertight guarantee

When you purchase or specify any Performa product, you are acquiring far more than a means of doing a job well. You are investing in unrivalled quality, service, value and reliability that has been over 100 years in the making. And that is why only Pegler Yorkshire gives you the added assurance of the unique watertight guarantee of quality.

- Robust designs backed by 5 year guarantee.
- Engineering excellence ensures reliability and durability.
- Suitable for a wide variety of applications.
- Backing of a full spares programme.
- Easy to service and main.
- Value for money.

## Key to symbols

Products in this brochure are accompanied by symbols intended to aid the reader by stating their ideal environments and key features. These symbols are:

### Usage

- ☺ Schools and nurseries
- 🎓 Senior schools and universities
- ⊕ Hospitals
- ⊕ Hospital public areas
- ♿ Care centres
- 🏠 Domestic
- 🖱 Office
- 🏭 Factories
- ⛺ Camp sites
- 🏨 Hotels
- 🏨<sup>P</sup> Hotel public areas
- ✈ Airports
- 🚗 Service areas
- 🚶 Leisure
- 👤 Public utilities
- 🛒 Shops
- 🍴 Restaurants and bars
- 🌊 Water applications
- Special needs**
- 💧 Water-saving
- 🔒 Tamper proof
- 👤 Special care
- ⊕ Healthcare
- 👤 Manual operation
- 🔊 Automatic operation
- 🌐 Approved to TMV3
- 🌐 Approved to TMV2
- 🕒 Time adjustment
- 🔧 Flow adjustment



- Design for longevity of life ■ 240v or 4 x AA batteries
- Electronic taps feature 8 hour autoflush feature
- Chrome plate tested to ISO 9227 (service condition 2)
- Electronics adjustable time from 1-22 seconds
- Electronic taps both EMC and LVD approved

### 401 Lever operated monobloc basin mixer

Connection	Finish	A	B	C	D	Order code
1/2"	Chrome	117	78	52	41	319007

Suitable for: ☺ ☼ ☽ ♿ 🏠 ✈️ 🚗 🚙 🚘 🚛 🚚 🚝 Special needs: 💧 🙌 Flow chart: Fig. 9, page 15

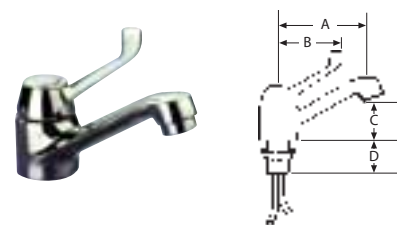

### T401 Thermostatic mono basin mixer

Handle rotation 225° (flexi hoses)

NEW

Connection	Finish	A	B	C	D	E	F	Order code
1/2"	Chrome	100	41	121	32	55 x 60	130	360050

Suitable for: ☺ 🏠 ☼ ☽ ♿ 🏠 ✈️ 🚗 🚙 🚘 🚛 🚚 🚝 Special needs: 🚘 🙌 🌐 Flow chart: Fig. 4, page 14

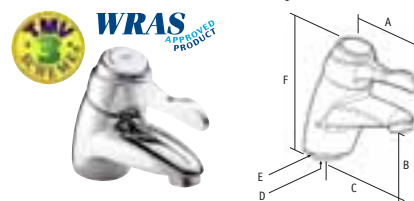

### 876 Self closing basin tap

Connection	Finish	A	B	C	D	E	Order code
1/2"	Chrome hot	16	76	1/2"	50	115	H 314007
1/2"	Chrome cold	16	76	1/2"	50	115	C 314017

Suitable for: 🏠 ☼ ☽ ♿ 🏠 ✈️ 🚗 🚙 🚘 🚛 🚚 🚝 Special needs: 💧 🙌 Flow chart: Fig. 3, page 14

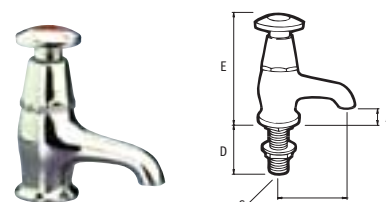

### 870-2 Self closing basin tap

NEW SPEC

Connection	Finish	A	B	C	D	E	F	Order code
1/2"	Chrome	140	70	1/2"	110	50	130	340006

Suitable for: ☺ 🏠 ☼ ☽ ♿ 🏠 ✈️ 🚗 🚙 🚘 🚛 🚚 🚝 Special needs: 💧 🙌 🌐 📺 Flow chart: Fig. 1, page 14

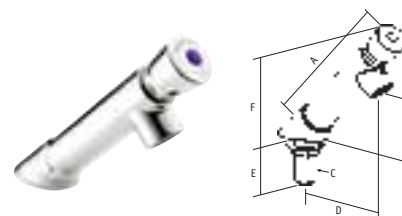

### 871 Self closing basin tap

NEW SPEC

Connection	Finish	A	B	C	D	E	F	G	Order code
1/2"	Chrome	230	164	55	45°	20	100	1/2"	341006

Suitable for: 🏠 ☼ ☽ ♿ 🏠 ✈️ 🚗 🚙 🚘 🚛 🚚 🚝 Special needs: 💧 🙌 🚘 📺 📺 Flow chart: Fig. 1, page 14

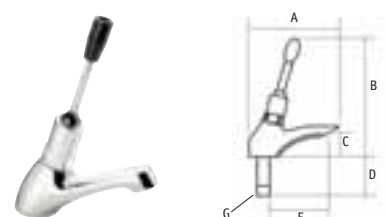

### 873 Self closing basin tap

Connection	Finish	A	B	C	D	Order code
1/2"	Chrome hot	25	78	145	70	H 313007
1/2"	Chrome cold	25	78	145	70	C 313017

Suitable for: 🏠 ☼ ☽ ♿ 🏠 ✈️ 🚗 🚙 🚘 🚛 🚚 🚝 Special needs: 💧 🙌 Flow chart: Fig. 8, page 15

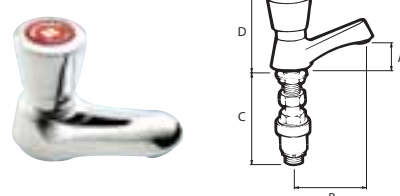

### 877-2 Self closing basin tap

Connection	Finish	A	B	C	D	E	Order code
1/2"	Chrome hot	35	100	1/2"	50	95	H 315037
1/2"	Chrome cold	35	100	1/2"	50	95	C 315038

Suitable for: 🏠 ☼ ☽ ♿ 🏠 ✈️ 🚗 🚙 🚘 🚛 🚚 🚝 Special needs: 💧 🙌 Flow chart: Fig. 8, page 15

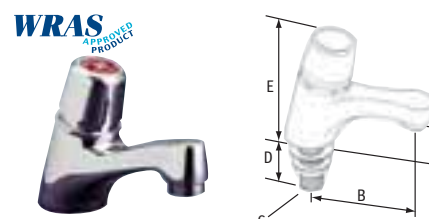

# Basin taps and mixers

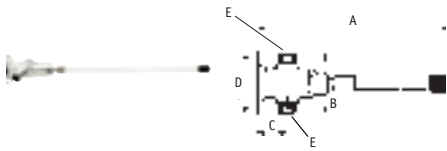

## 882 Lever operated flow control

Connection	Finish	A	B	C	D	E	Order code
1/2"	Chrome	430	70	35	60	1/2"	342009

Suitable for: Special needs: Flow chart: Fig. 1, page 14

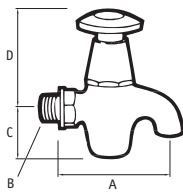

## 880 Self closing bibtap

Connection	Finish	A	B	C	D	Order code
1/2"	Chrome hot	87	1/2"	41	75	H 317007
1/2"	Chrome cold	87	1/2"	41	75	C 317017

Suitable for: Special needs: Flow chart: Fig. 3, page 14

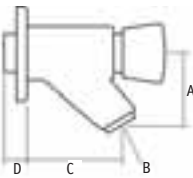

## 883-2 Self closing bibtap

**NEW SPEC**

Connection	Finish	A	B	C	D	E	Order code
1/2"	Chrome	40	25°	45	21	1/2"	347006

Suitable for: Special needs: Flow chart: Fig. 1, page 14

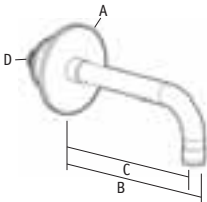

## 897-2 Wall mounted basin spout

Connection	Finish	A	B	C	D	Order code
1/2"	Chrome	96	197	185	1/2"	346006

Suitable for: Flow chart: Fig.7, page 15

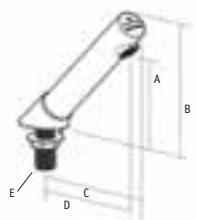

## 899-2 Deck mounted basin spout

Connection	Finish	A	B	C	D	E	Order code
1/2"	Chrome	105	145	140	125	1/2"	346010

Suitable for: Flow chart: Fig.7, page 15

## Water saving taps

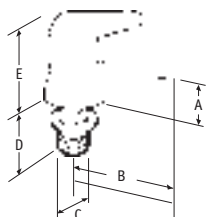

## Leger CP basin taps

**WATER SAVING**

Connection	Finish	A	B	C	D	E	Order code
1/2"	Chrome	24	77	1/2"	50	79	4B7040

Suitable for: Special needs: Flow chart: Fig. 5, page 14

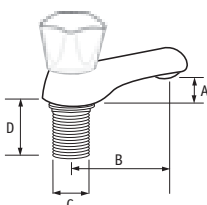

## Danum CP basin taps Washered valves. Ceramic disc

**WATER SAVING**

Connection	Finish	A	B	C	D	Order code
1/2"	Washed Chrome	24	77	1/2"	50	404011
1/2"	CD Chrome	24	77	1/2"	50	404069

Suitable for: Special needs: Flow chart: Fig. 5, page 14



- Water saving taps to 4-0 c/m (+/-15%)
- Brass backnuts used where applicable ■ Use WRAS approved materials
- Products listed on BMA labelling scheme (where shown)
- Water saving taps suitable for domestic and commercial applications

Souvenir CP basin taps								WATER SAVING
Connection	Finish	A	B	C	D	E	F	Order code
1/2"	Chrome	33	85	1/2"	50	43	90	4W9040

Suitable for: Special needs: Flow chart: Fig. 5, page 14

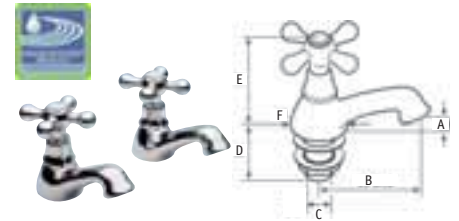

Polo CP basin taps							WATER SAVING
Connection	Finish	A	B	C	D	Order code	
1/2"	Chrome	67	1/2"	72	28	434005	

Suitable for: Special needs: Flow chart: Fig. 5, page 14

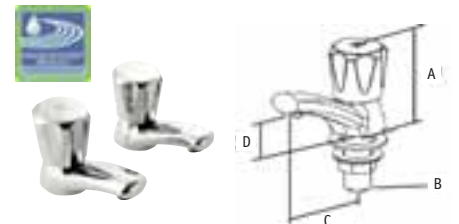

2159 Performa CP basin taps To BS 5412								WATER SAVING
Connection	Finish	A	B	C	D	E	Order code	
1/2"	Chrome	20	70	1/2"	50	102	301028	

Suitable for: Special needs: Flow chart: Fig. 5, page 14

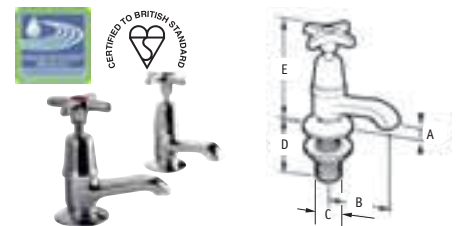

2159QT Performa CP basin taps									WATER SAVING
Connection	Finish	A	B	C	D	E	F	Order code	
1/2"	Chrome	65	21	70	1/2"	50	88	308048	

Suitable for: Special needs: Flow chart: Fig. 5, page 14

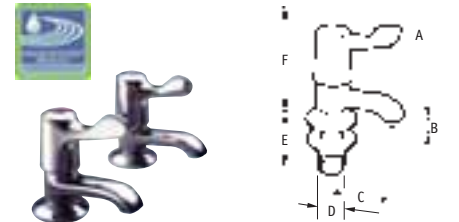

2159QTSL Performa CP basin taps									WATER SAVING
Connection	Finish	A	B	C	D	E	F	Order code	
1/2"	Chrome	25	21	70	1/2"	50	80	324068	

Suitable for: Special needs: Flow chart: Fig. 5, page 14

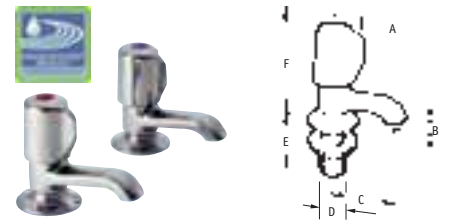

2159QTEL Performa CP basin taps									WATER SAVING
Connection	Finish	A	B	C	D	E	F	Order code	
1/2"	Chrome	70	125	21	1/2"	50	104	330030	

Suitable for: Special needs: Flow chart: Fig. 5, page 14

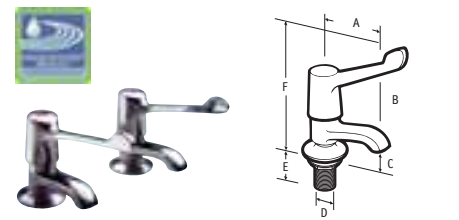

159 Performa CP basin taps To BS1010								WATER SAVING
Connection	Finish	A	B	C	D	E	Order code	
1/2"	Chrome	20	70	1/2"	50	102	304018	

Suitable for: Special needs: Flow chart: Fig. 5, page 14

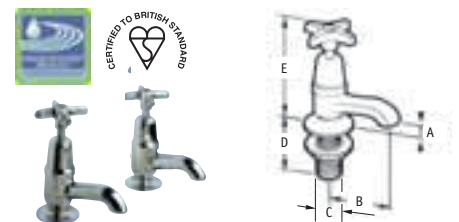

# Showers

The perfect solution to saving water in single and multiple installations.  
Ideal for all frequent showering applications where water safety is important.

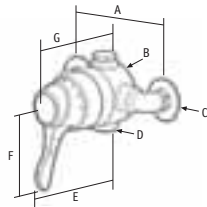

## 894 Exposed sequential shower

NEW

Connection	Finish	A	B	C	D	E	F	G	Order code
1/2"	Chrome	138 - 145	70	45	1/2"	140	100	135	360051

Suitable for: Special needs: Flow chart: Fig. 11, page 15

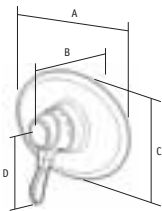

## 895 Concealed sequential shower *designed to TMI of HTM64*

NEW

Connection	Finish	A	B	C	D	Order code
1/2"	Chrome	215	130	150	100	360052

Suitable for: Special needs: Flow chart: Fig. 11, page 15

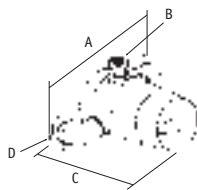

## 888 Exposed dual control shower

NEW

Connection	Finish	A	B	C	D	Order code
1/2"	Chrome	138 - 145	1/2"	137	45	360053

Suitable for: Special needs: Flow chart: Fig. 10, page 15

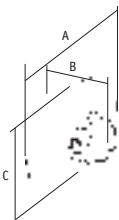

## 889 Concealed dual control shower

NEW

Connection	Finish	A	B	C	Order code
1/2"	Chrome	215	132	150	360054

Suitable for: Special needs: Flow chart: Fig. 10, page 15

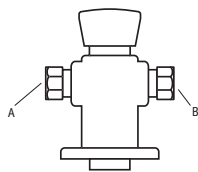

## 890-2 Self closing shower flow control

NEW SPEC

Size	Finish	A	B	Order code
1/2"	Chrome	1/2"	1/2"	344007

Suitable for: Special needs: Flow chart: Fig. 12, page 15

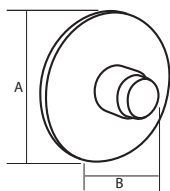

## 893-2 Self closing shower flow control

NEW SPEC

Connection	Finish	A	B	Order code
1/2"	Chrome	115	30-45	344010

Suitable for: Special needs: Flow chart: Fig. 12, page 15

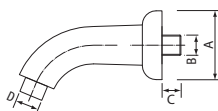

## Straight shower arm

NEW

Connection	Finish	A	B	C	D	Order code
1/2"	Chrome	60	1/2"	60 - 20	1/2" BSP	345024

- Use WRAS approved materials
- Where applicable products designed to BS EN 111, BS EN 1287 or BS 7942
- Multi functional shower heads
- Chrome plate tested to ISO 9227 (service condition 2)

Bent shower arm					NEW
Connection	Finish	A	B	C	Order code
1/2"	Chrome	1/2"	92	160	345025

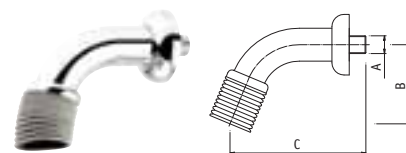

3 Mode curved handset				
Connection	Finish	A	B	Order code
1/2"	Chrome	700	52	4S4534

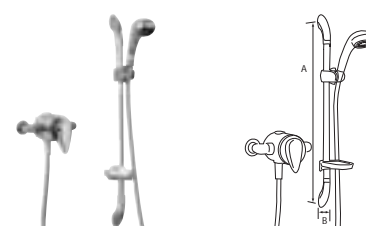

Suitable for: Special needs:

Single spray shower head and arm						NEW
Connection	Finish	A	B	C	D	Order code
1/2"	Chrome	170	1/2"	60	80	345020

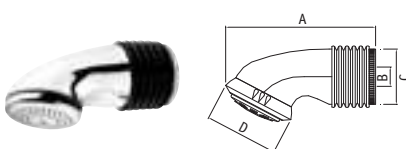

Flow chart: Fig. 13, page 16

3 Mode low pressure shower head (90mm)					NEW
Size	Finish	A	B	Order code	
90mm	Chrome	1/2"	90	345021	

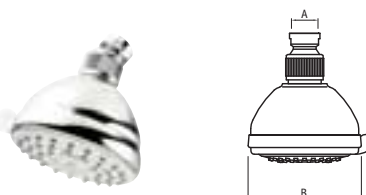

Flow chart: Fig. 13, page 16

3 Mode low pressure shower head (70mm)					NEW
Size	Finish	A	B	Order code	
70mm	Chrome	1/2"	70	345022	

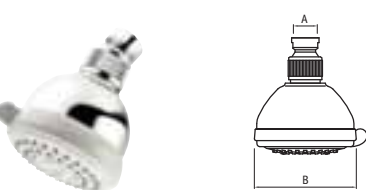

Flow chart: Fig. 13, page 16

7 Mode low pressure shower head (90mm)					NEW
Size	Finish	A	B	Order code	
90mm	Chrome	1/2"	90	345023	

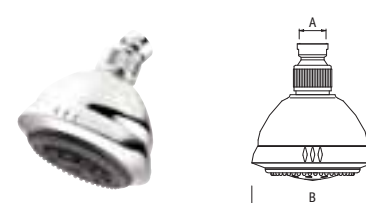

Flow chart: Fig.13, page 16

## Mixing valves

In line mixing valves are designed to eliminate the risk of scalding and are suitable for use in a wide range of applications.

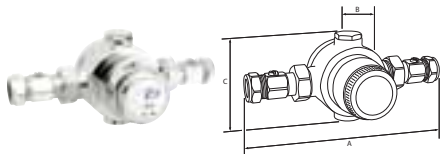

### 410 Group mixing valve\*

NEW

Size	Finish	A	B	C	Order code
22mm	Chrome	242	115	108	5A1060

Suitable for: ☺ 🐟 ♿ ♿ ♿ ♿ ♿ ♿ Special needs: 🏠 + 🌡️ Flow chart: Fig.14, page 16

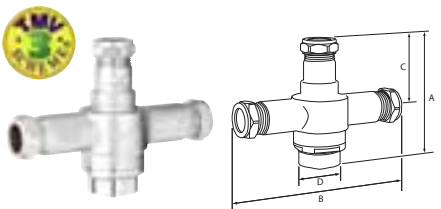

### 402HF3 In line thermostatic mixing valve\*

Copper x copper

NEW

Size	Finish	A	B	C	D	Order code
22mm	Chrome	128	177	75	50	5A1007

Suitable for: ♿ ♿ ♿ ♿ ♿ Special needs: 🏠 + 🌡️ Flow chart: Fig.14, page 16

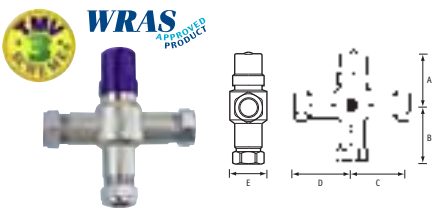

### 402H In line thermostatic mixing valve\*

Copper x copper

Size	Finish	A	B	C	D	E	Order code
15-22mm	Nickel plate	68	63	67	67	43	5A1002

Suitable for: ☺ 🐟 ♿ ♿ ♿ ♿ ♿ Special needs: 🏠 + 🌡️ Flow chart: Fig. 16, page 16

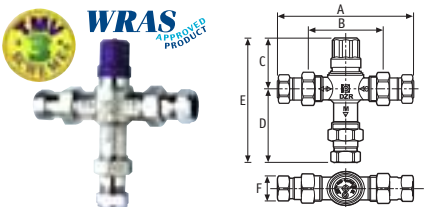

### 402U In line thermostatic mixing valve\*

Flanged connections. Copper x copper

Size	Finish	A	B	C	D	E	F	Order code
15-22mm	Nickel plate	159	88	60	88	148	43	5A1003

Suitable for: ☺ 🐟 ♿ ♿ ♿ ♿ ♿ Special needs: 🏠 + 🌡️ Flow chart: Fig. 16, page 16

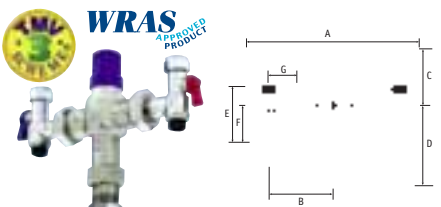

### 402UA In line thermostatic mixing valve\*

With angle valves. Copper x copper

Size	Finish	A	B	C	D	E	F	G	Order code
15mm	Nickel plate	210	80	65	100	70	45	35	5A1004
22mm	Nickel plate	224	90	65	100	90	60	45	5A1005

Suitable for: ☺ 🐟 ♿ ♿ ♿ ♿ ♿ Special needs: 🏠 + 🌡️ Flow chart: Fig. 16, page 16

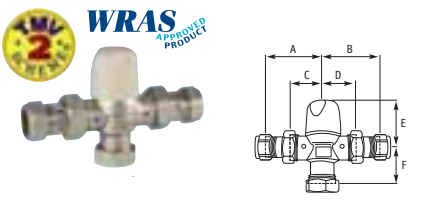

### 404 In line thermostatic mixing valve\*

Copper x copper

Size	Finish	A	B	C	D	E	F	Order code
15mm	Nickel plate	72	72	38	38	58.1	43	5A1020
22mm	Nickel plate	72	72	38	38	58.1	43	5A1021

Suitable for: ☺ 🐟 ♿ ♿ ♿ ♿ ♿ Special needs: 🏠 + 🌡️

Flow chart: Fig. 15, page 16



Figure 1: 870-2/883-2/882/871-2 (taps)

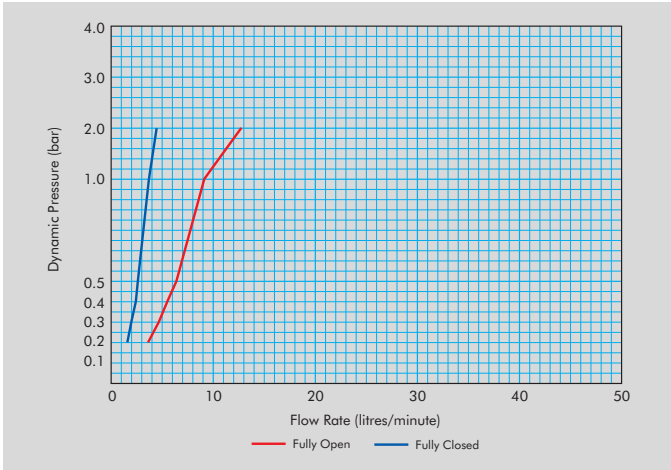

Figure 4: T401 (taps)

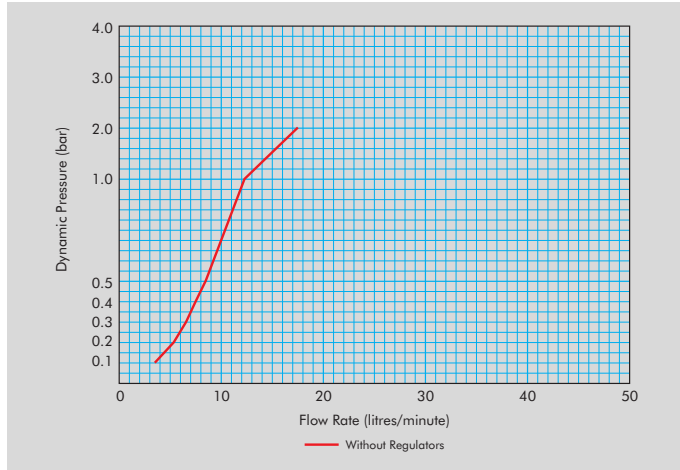

Figure 2: 885-2/887-2 (taps)

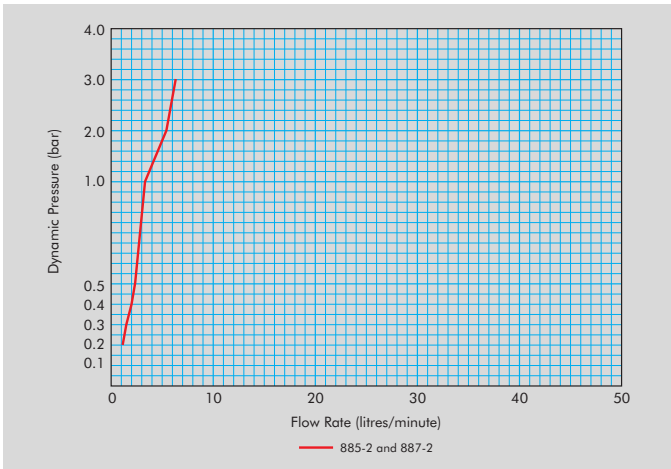

Figure 5: Eco taps 4.0l/m +/-15% (taps)

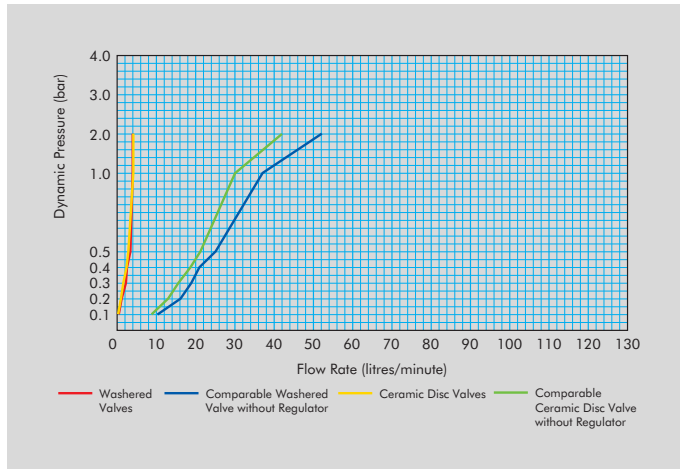

Figure 3: 876/880/884 (taps)

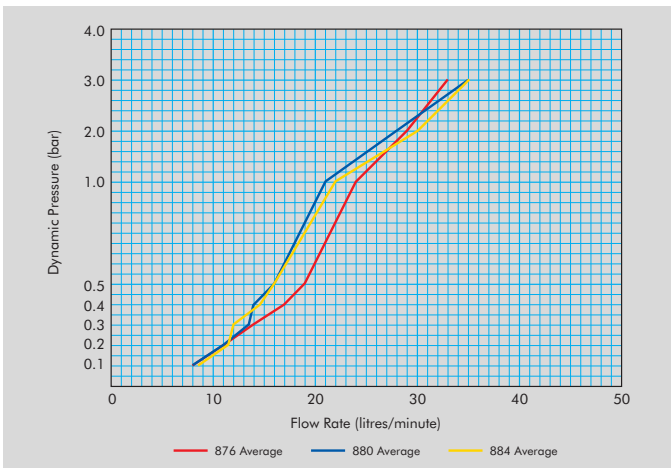
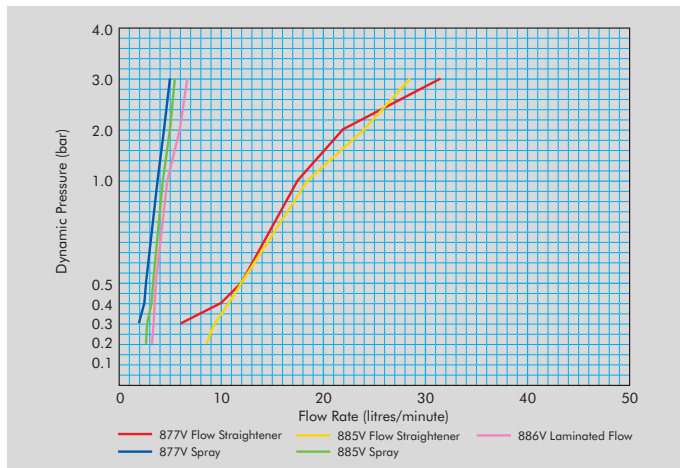
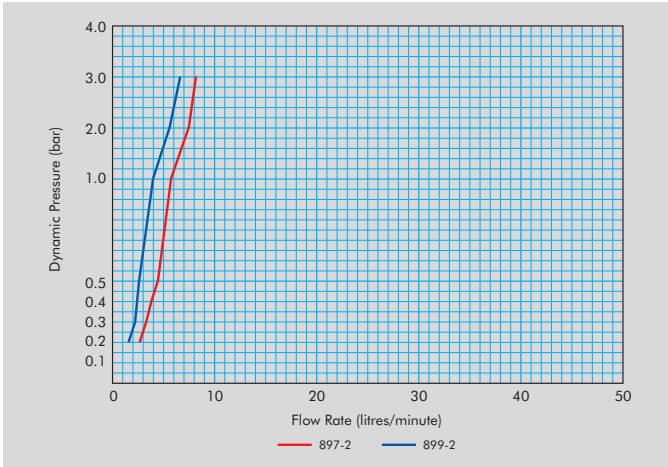

Figure 6: 877V/885V/886V (taps)



**Figure 7: 897-2/899-2 (taps)**



**Figure 10: 888/889 (showers)**

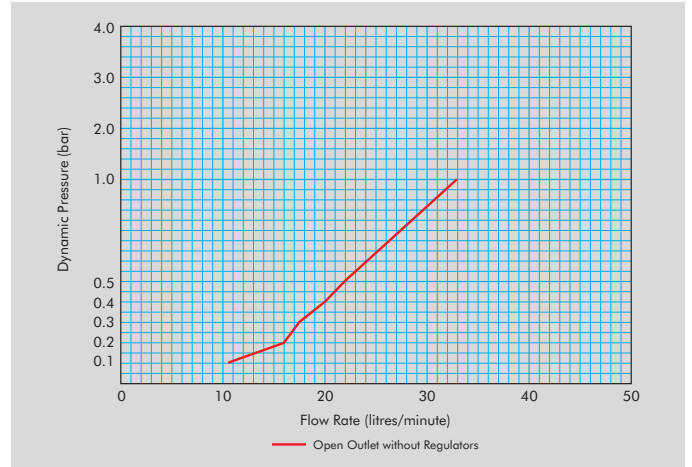

**Figure 8: 877-2/873 (taps)**

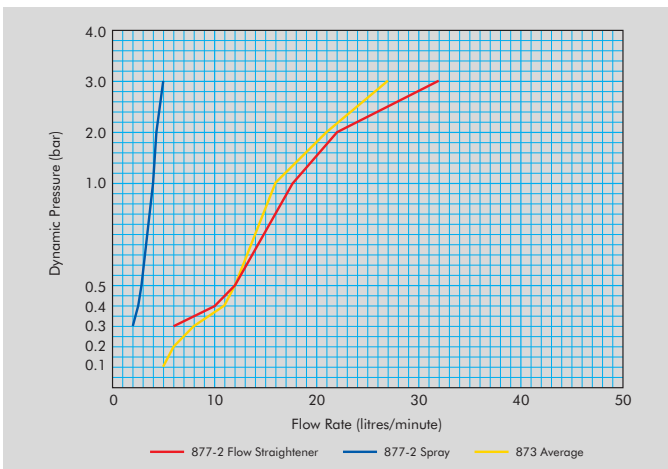

**Figure 11: 894/895 (showers)**

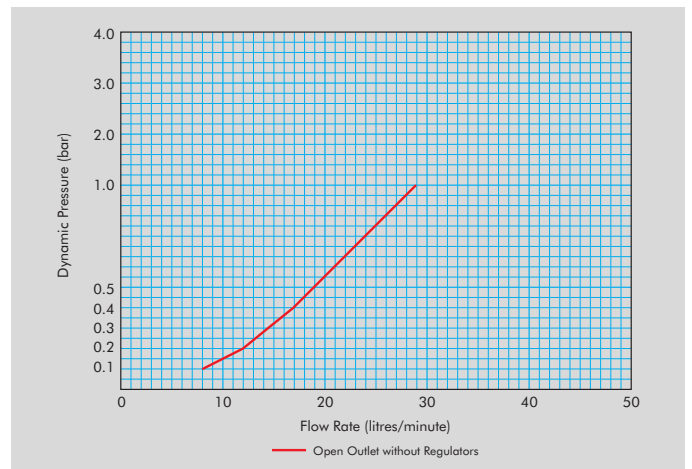

**Figure 9: 401 (taps)**

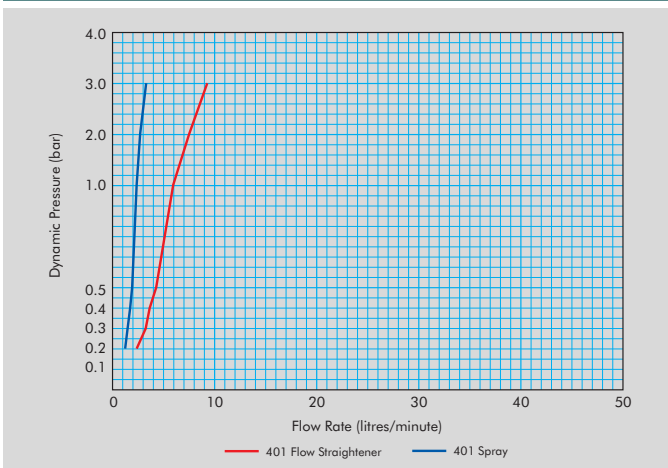

**Figure 12: 890-2/893-2 (showers)**

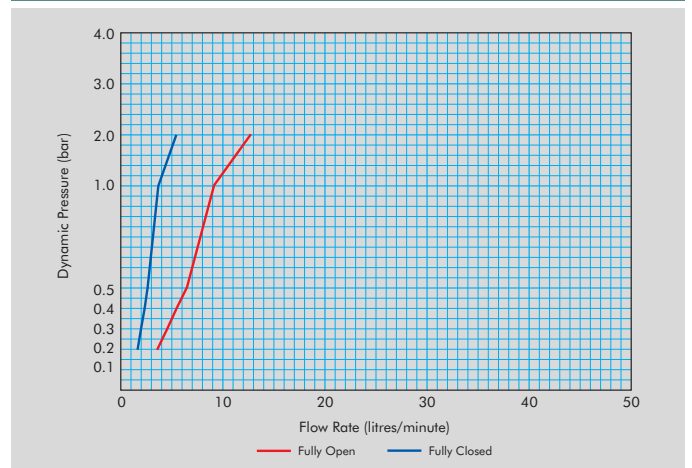

**Figure 13: Shower heads**

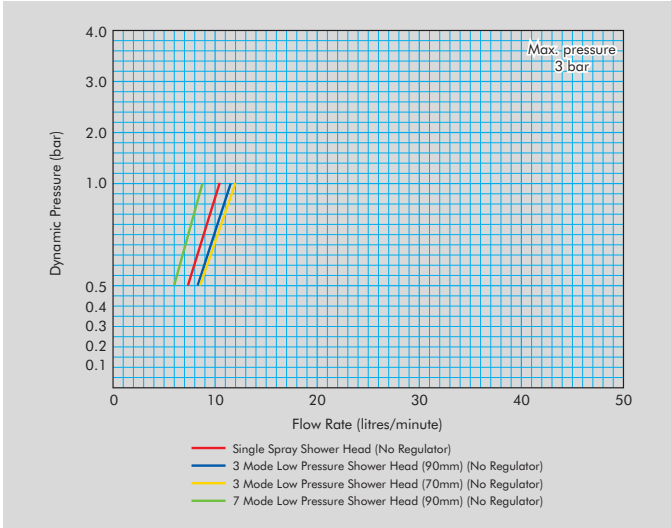

**Figure 16: 402H/402U/402UA 15mm/  
402UA 22mm (mixing valves)**

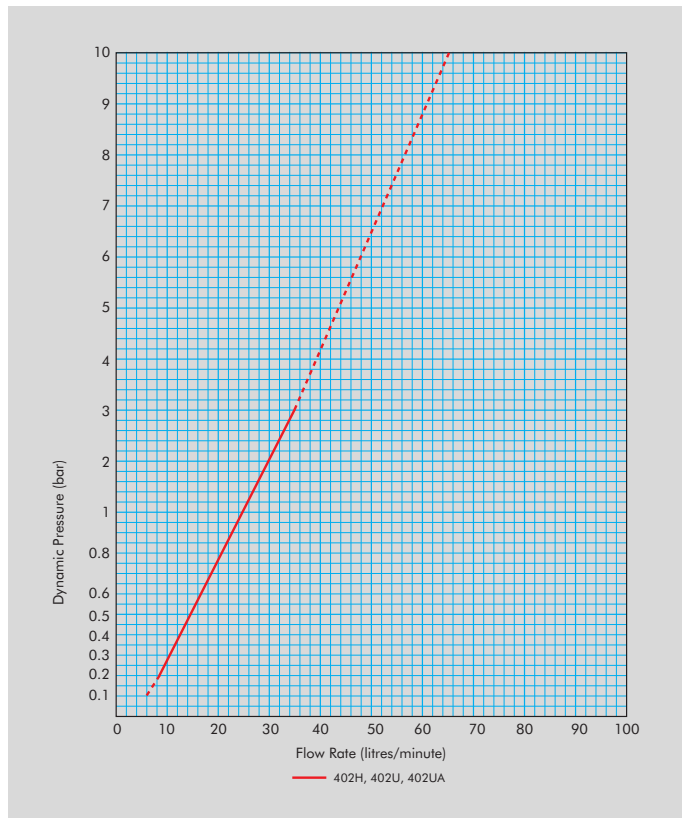

**Figure 14: 402HF3/410 (mixing valves)**

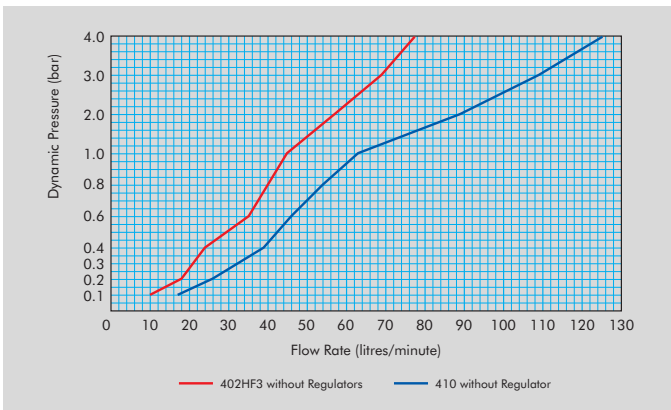

**Figure 15: 404 15mm/404 22mm/404UA  
15mm/404UA 22mm (mixing valves)**

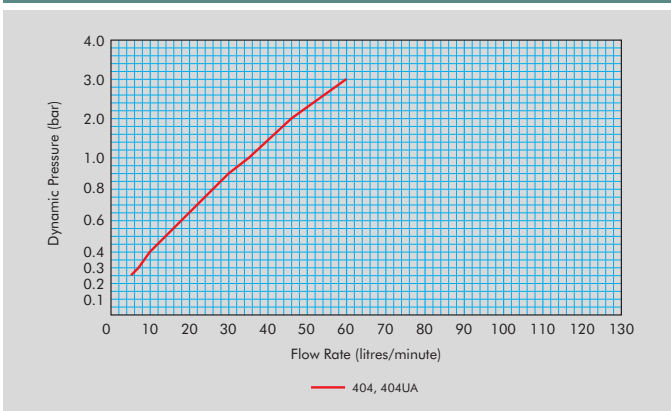



# Optiflush Urinal flush controller

## Standards & water regulation requirements

The Water Regulations are concerned with the amount of water utilised per hour in the flushing process. The table below summarises the maximum flow requirements per urinal bowl/slab.

These requirements combined with those of BS 6700 which state that no more than 3 flushes per hour are permissible clearly demand an accurate means of control.

The Optiflush is designed to give you the maximum amount of flexibility in set up to ensure that every installation is capable of complying with the water byelaws and BS 6700

Number of Urinals Bowls/slabs	Maximum Flow Requirement (litres per hour)
1	10
2	15
3	22.5
4	30
5	37.5
6	45

**Note:** Figures for two or more bowls/slabs are calculated based on using 7.5 litres per hour per bowl as a maximum.

## Recommended fill time settings

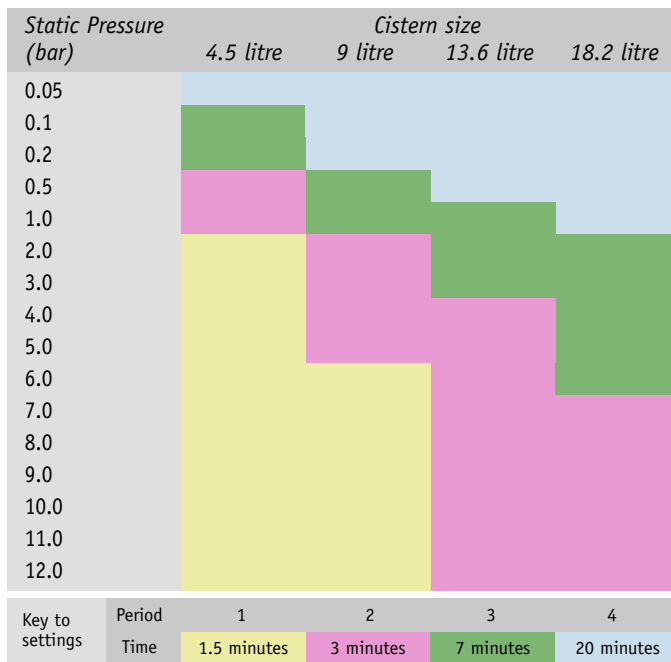

## Detection area

Horizontal Area: Viewed From Above

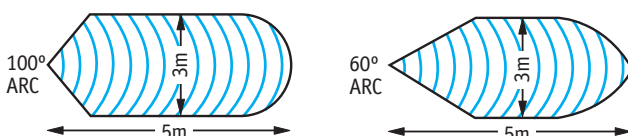

## Recommended delay time

Number of Urinals Bowls/slabs	A (20 minutes)	B (30 minutes)	C (40 minutes)
1	-	4.5 litre Cistern	-
2	4.5 litre Cistern	-	9 litre Cistern
3	-	9 litre Cistern	13.6 litre Cistern
4	9 litre Cistern	13.6 litre Cistern	18.2 litre Cistern
5	9 litre Cistern	18.2 litre Cistern	-
6	13.6 litre Cistern	18.2 litre Cistern	-

## How it works

### (1) Pick up

The Optiflush's passive infra-red detector senses movement in the cloakroom.



### (2) Delay

Knowledge that the cloakroom has been utilised is then stored by the Optiflush for a pre-set delay period (determined by the installer).

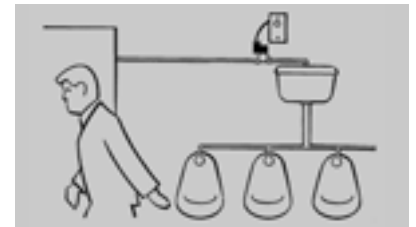

### (3) Delay

During the delay period, subsequent users of the cloakroom are not detected by the Optiflush.



### (4) Flush

The Optiflush activates the solenoid latching valve and water is released for a measured length of time to fill the cistern and subsequently flush the urinals.

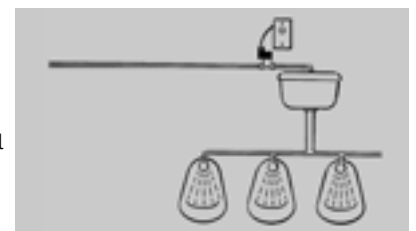

### (5) Re-set

Once the flushing operation is complete, the Optiflush closes the valve, re-sets itself and awaits the next user to begin the cycle again.

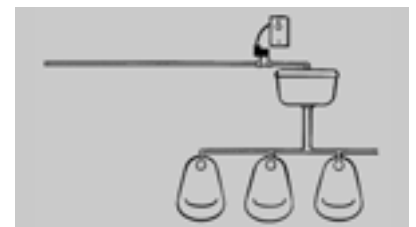

*Our brands:*



*Also available from  
Pegler Yorkshire:*



*Performa technical helpline*  
Tel 0870 120 0285

For sales information, please contact:

## UK regions

### *Northern team*

Tel 0870 120 0281 Fax 01302 560108

Email [north.sales@pegler.yorkshire.co.uk](mailto:north.sales@pegler.yorkshire.co.uk)

### *Southern team*

Tel 0870 120 0282 Fax 01302 560458

Email [south.sales@pegler.yorkshire.co.uk](mailto:south.sales@pegler.yorkshire.co.uk)

### *Western team*

Tel 0870 120 0283 Fax 01302 560109

Email [west.sales@pegler.yorkshire.co.uk](mailto:west.sales@pegler.yorkshire.co.uk)

### *Eastern team*

Tel 0870 120 0282 Fax 01302 560458

Email [east.sales@pegler.yorkshire.co.uk](mailto:east.sales@pegler.yorkshire.co.uk)

## Worldwide exports

Tel +44 (0) 1302 855656

Fax +44 (0) 1302 730513

Email [export@pegler.co.uk](mailto:export@pegler.co.uk)

[www.yorkshirefittings.co.uk](http://www.yorkshirefittings.co.uk)

Pegler Limited, St. Catherine's Avenue,  
Doncaster, South Yorkshire, DN4 8DF, England.  
Registered Company No. 01194543  
Place of Registration: England

Yorkshire Limited, Haigh Park Road, Stourton,  
Leeds, West Yorkshire, LS10 1RT, England.  
Registered Company No. 00401507  
Place of Registration: England

All brand names and logo styles are registered trademarks.  
Maintaining a policy of continual product development, Pegler  
Yorkshire reserves the right to change specifications, design and  
materials of products listed in this leaflet without prior notice.  
LIT.REF: 880105.07.08